

HOUSING

Part No:KJ-4258HF-2
 Material:Nylon66 UL94-V2
 Circuits: 2-24circuits available
 Insulation Resistance:1000MΩ min
 Withstand Voltage:1500V AC/minute
 Current Rating:9A AC/DC
 Voltage Rating:600V AC/DC

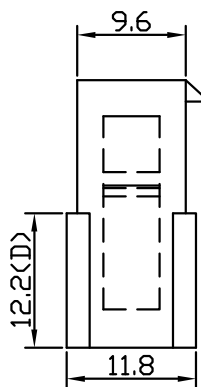
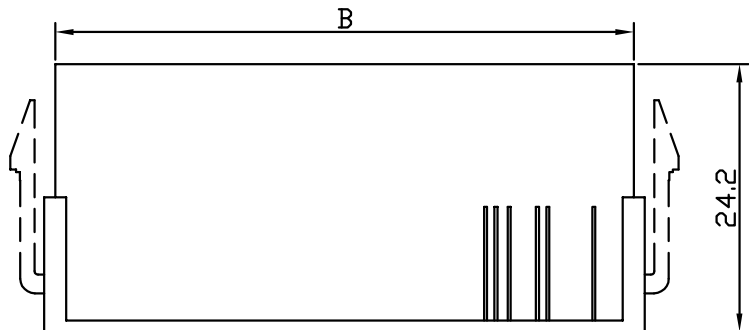
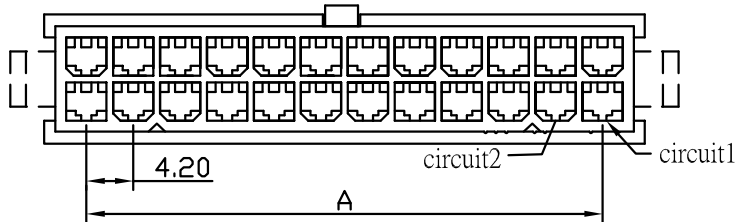
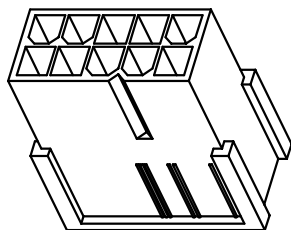
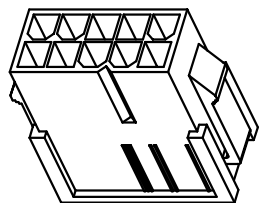

ORDERING INFORMATION:

RoHS

KJ-4258HF*-2*P-* (*)

Part No
 :With Ear
 N:Without Ear
 2 : Double Row
 Circuit No
 Special Material:V-0
 Color

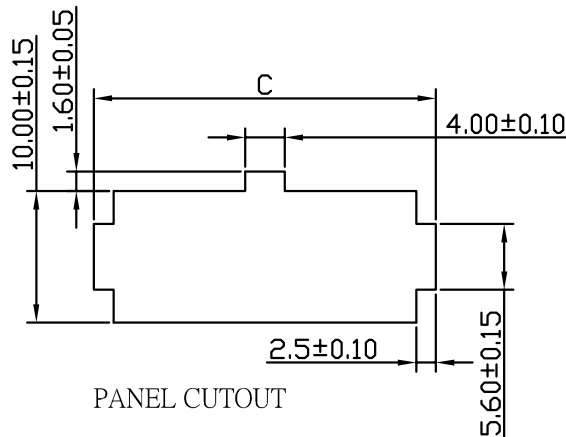

PANEL CUTOUT

MAX PANEL THICKNESS:2.00±0.10

Dimensions

circuit	A	B	C	circuit	A	B	C
2*1	-	5.4	10.80	2*7	25.20	30.6	36.00
2*2	4.20	9.6	15.00	2*8	29.40	34.8	40.20
2*3	8.40	13.8	19.20	2*9	33.60	39.0	44.40
2*4	12.60	18.0	23.40	2*10	37.80	43.2	48.60
2*5	16.80	22.2	27.60	2*11	42.00	47.4	52.80
2*6	21.00	26.4	31.80	2*12	46.20	51.6	57.00

KJ 東莞嘉英電子廠
 JIA YING ELECTRONICS

UNIT:MM

繪圖
DRAWING:

王三星

比例 (SCALE):

2.5:1

DESCRIPTION:

MX4.2 MINI-FIT FEMALE HOUSING

ANGLE
±2°

DIM:
.X±0.50
.XX±0.20
.XXX±0.10

審核
CHECKED BY

凌輝

名稱 (TITLE):

4.2 HOUSING

存檔名稱 (FILE):

KJ-4258HF-2

日期 (DATE):

2009/06/19

PART NO:

KJ-4258HF-2

REV:A4

核准
APPROVAL BY

苗德蕙

PROJECTION:

