

WAFER(90°)

Part No:KJ-2501WR

Material:Pin:Brass Tin-Plated

Base:Nylon66 UL94-V0

Circuits:2-20circuits available

Insulation Resistance: 1000M Ω min

Withstand Voltage: 1000V AC/minute

Current Rating: 3A AC/DC

Voltage Rating: 250V AC/DC

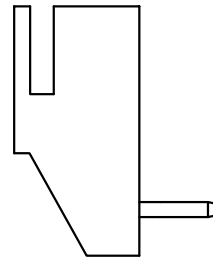
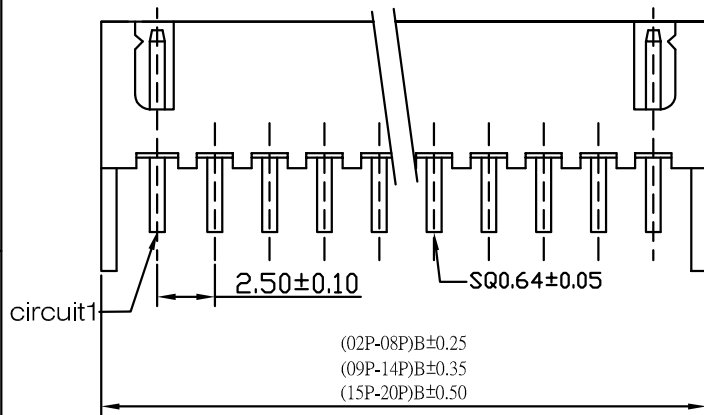
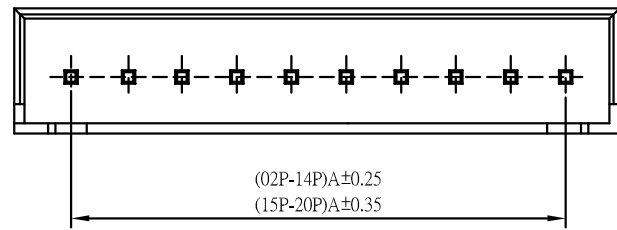

None Kink

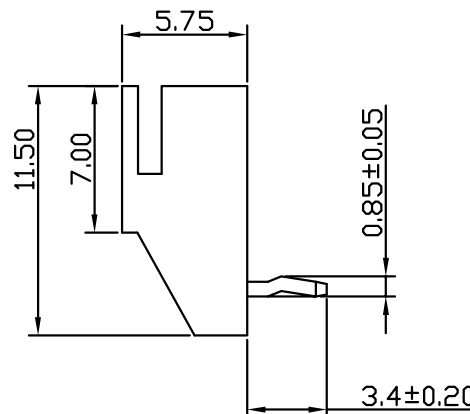

Standard Type

ORDERING INFORMATION: **RoHS**
KJ-2501WR-*P-*-* (*)

Part No

Circuit No

Special Material:PA46
6T

Color

:Standard Type W/Kink
NK:None Kink

:Tin plated
M:Matte-tin plated
G:Gold flash
G1:Gold 1u"

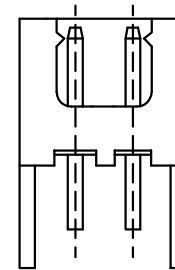

2P

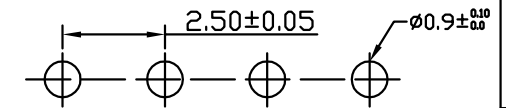

Dimensions P.C.B LAYOUT

Circuit	A	B	Circuit	A	B
2	2.50	7.50	12	27.50	32.50
3	5.00	10.00	13	30.00	35.00
4	7.50	12.50	14	32.50	37.50
5	10.00	15.00	15	35.00	40.00
6	12.50	17.50	16	37.50	42.50
7	15.00	20.00	17	40.00	45.00
8	17.50	22.50	18	42.50	47.50
9	20.00	25.00	19	45.00	50.00
10	22.50	27.50	20	47.50	52.50
11	25.00	30.00			

KJ 東莞嘉英電子廠
JIA YING ELECTRONICS

UNIT:MM

繪圖
DRAWING:

王三星

比例 (SCALE):

3:1

DESCRIPTION:

XH2.5 WAFER 90°

ANGLE
±2°

DIM:
.X±0.50
.XX±0.25
.XXX±0.10

審核
CHECKED BY

凌輝

名稱 (TITLE):

XH2.5 90°

PART NO:

KJ-2501WR

REV:A2

核准
APPROVAL BY

苗德蕙

存檔名稱 (FILE):

KJ-2501WR

日期 (DATE):

2009/07/08

PROJECTION:

