

ORDERING INFORMATION:
 KJ-3961WV-*P-* * (*)
 Part No
 Circuit No (pin位)
 Special Material:V-0
 Color
 :Tin plated
 M:Matte-tin plated
 G:Gold flash
 G1:Gold 1u"

RoHS
 WAFER(90°)
 Part No:KJ-3961WR
 Material: pin:Brass tin-plated
 Base:Nylon 66 UL94-V2
 Circuits: 2-20circuits available
 Insulation resistance:1000M Ω min
 Withstand Voltage:800V AC/minute
 Current Rating:6.5A AC/DC
 Voltage Rating:250V AC/DC

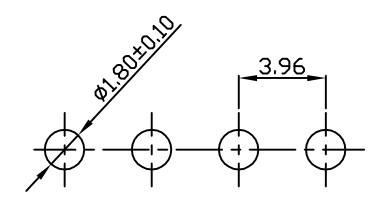
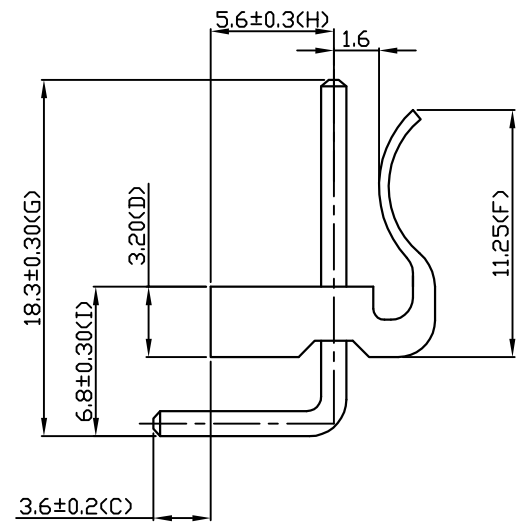
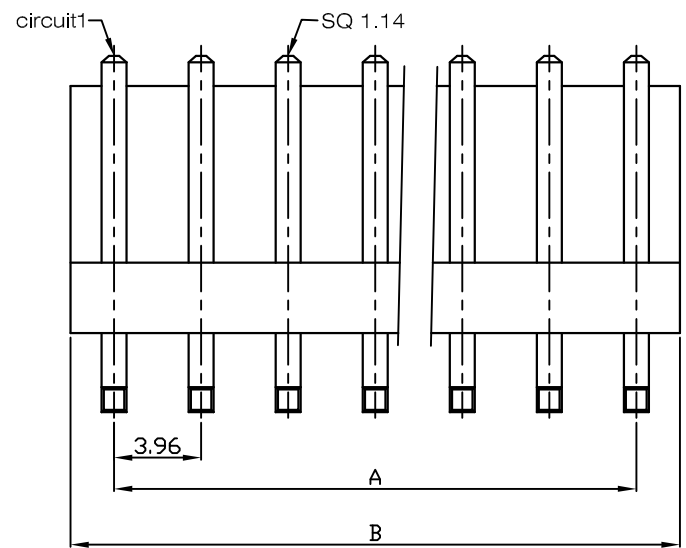

P.C.B. LAYOUT

Dimensions

circuit	A	B	circuit	A	B
		3.96	11	39.60	43.56
2	3.96	7.92	12	43.56	47.52
3	7.92	11.88	13	47.52	51.48
4	11.88	15.84	14	51.48	55.44
5	15.84	19.80	15	55.44	59.40
6	19.80	23.76	16	59.40	63.36
7	23.76	27.72	17	63.36	67.32
8	27.72	31.68	18	67.32	71.28
9	31.68	35.64	19	71.28	75.24
10	35.64	39.60	20	75.24	79.20

KJ 東莞嘉英電子廠
 JIA YING ELECTRONICS

UNIT:MM

繪圖
DRAWING:

王三星

比例 (SCALE):

3:1

DESCRIPTION:

MX3.96 WAFER 90° 彎靠背

ANGLE
±2°

DIM:
.X±0.50
.XX±0.25
.XXX±0.10

審核
CHECKED BY

凌輝

名稱 (TITLE):

MX3.96彎靠背

PART NO:

KJ-3961WR

REV:A2

核准
APPROVAL BY

苗德蕙

存檔名稱 (FILE):

KJ-3961WR

日期 (DATE):

2007/12/24

PROJECTION:

